

EXCELSIOR REDWOOD CO'S. SHINGLE MILL.
 Capacity 100,000 in 10 hours.
 POWER STEAM - FUEL KEROSENE - LIGHTS ELECTRIC -
 NIGHT & SUNDAY WATCHMAN -
 WATER FROM TANK FILLED FROM DRY - TANK CONNECTED WITH STEAM PUMP.
 HYDS. & HOSE AS SHOWN WITH STEAM PUMP PRESSURE -
 STEAM UP AT ALL TIMES - SPRINKLERS ON ROOF OF MILL CONNECTED WITH PUMP.
 WATER BLS. ON ROOFS & BLS. & BUCKETS IN MILL.
 SIDES & ROOFS OF ALL BLDGS. ARE WHITENASHED.

Located 6 Miles East of Eureka & 1 Mile off Arcata Road.

267

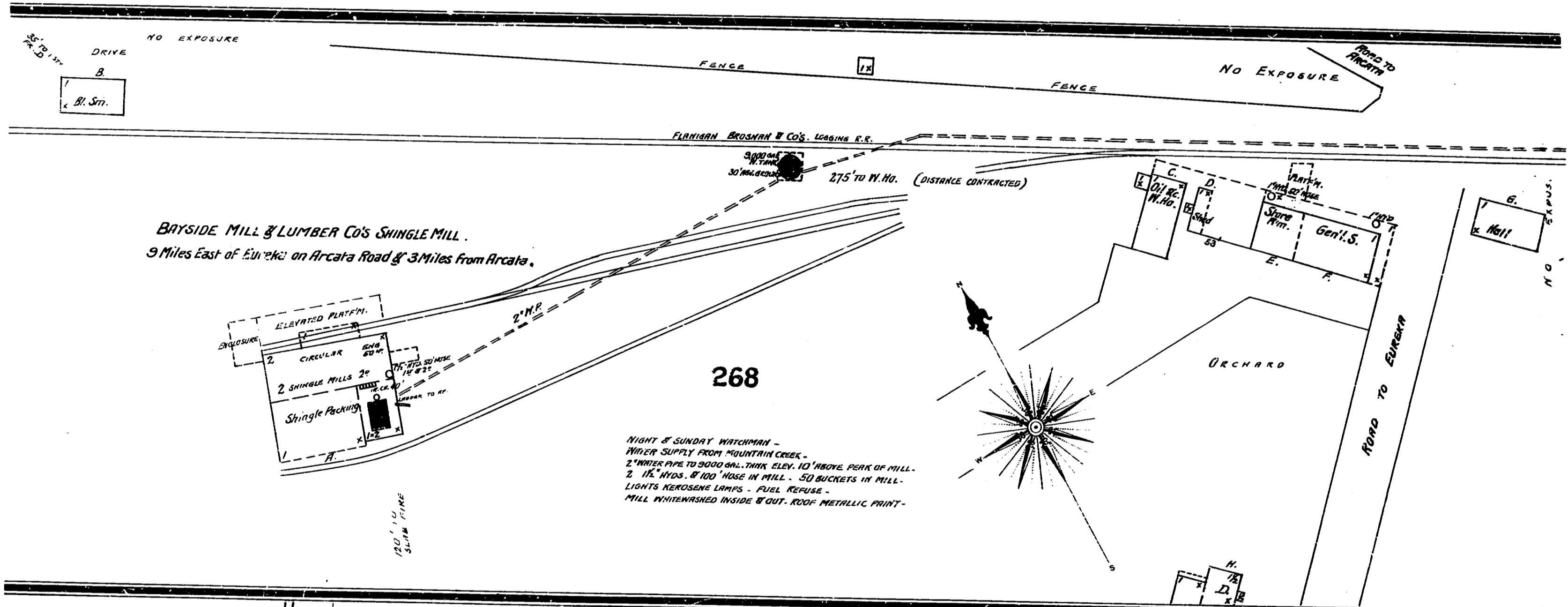

BAYSIDE MILL & LUMBER CO'S SHINGLE MILL.
 9 Miles East of Eureka on Arcata Road & 3 Miles from Arcata.

NIGHT & SUNDAY WATCHMAN -
 WATER SUPPLY FROM MOUNTAIN CREEK.
 TANK ELEV. 10' ABOVE PEAK OF MILL.
 2" WATER PIPE TO 5000 GAL. TANK. 10' HOSE IN MILL. - 50 BUCKETS IN MILL.
 LIGHTS KEROSENE LAMPS - FUEL KEROSENE -
 MILL WHITENASHED INSIDE & OUT. ROOF METALLIC PAINT.

268

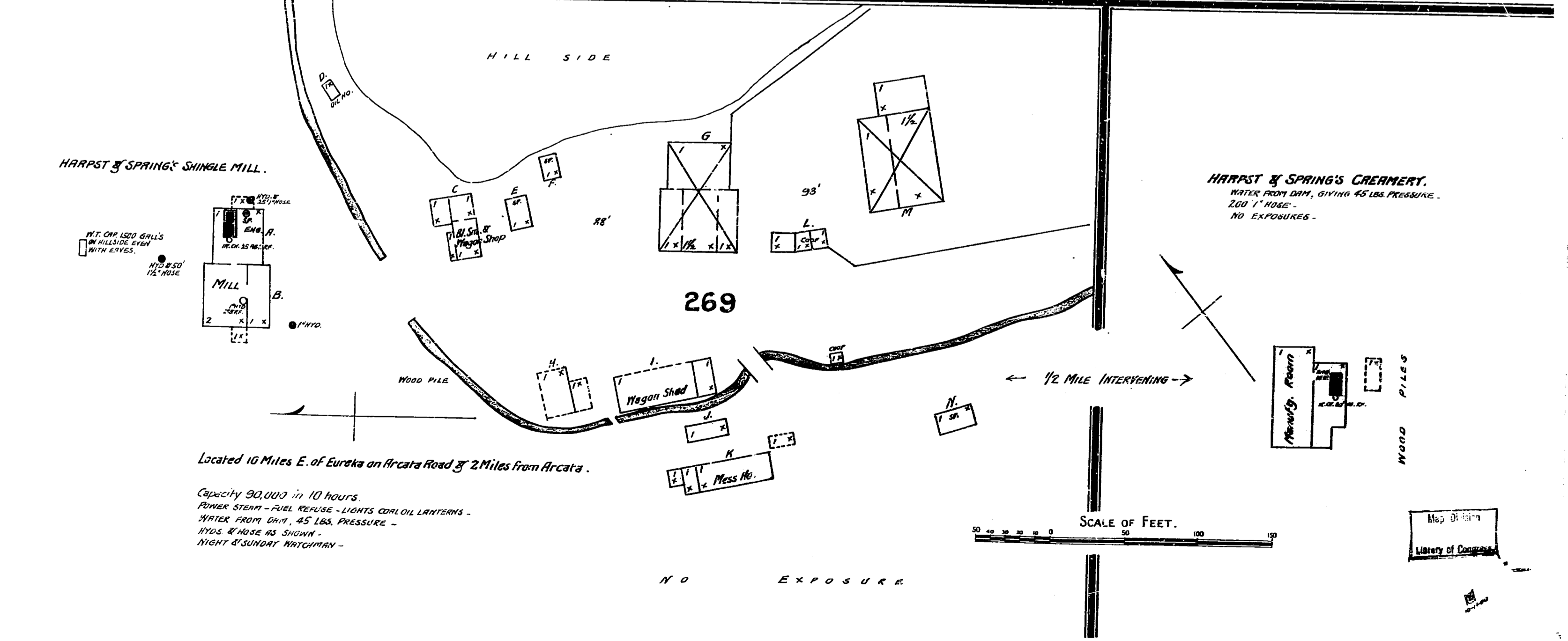

HARPST & SPRING'S SHINGLE MILL.

HARPST & SPRING'S CREAMERY.
 WATER FROM DAM, GIVING 45 LBS. PRESSURE.
 200' HOSE -
 NO EXPOSURES.

Located 10 Miles E. of Eureka on Arcata Road & 2 Miles from Arcata.

Capacity 90,000 in 10 hours.
 POWER STEAM - FUEL KEROSENE - LIGHTS COAL OIL LANTERNS -
 WATER FROM DAM, 45 LBS. PRESSURE -
 HYDS. & HOSE AS SHOWN -
 NIGHT & SUNDAY WATCHMAN -

NO EXPOSURE

SCALE OF FEET.

Map of Harpst & Spring
 Library of Congress